

STANDARD ABUTTING SIDEWALK SECTION  
 N.T.S.

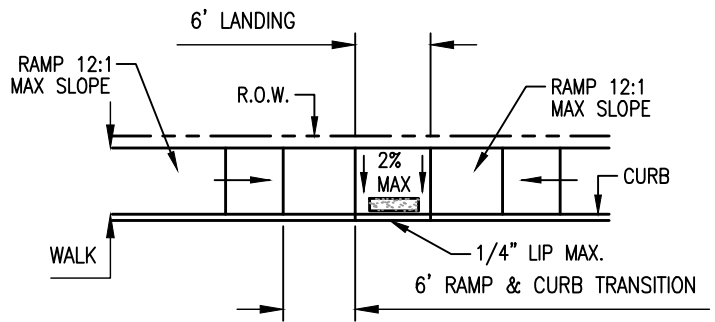

MID-BLOCK RAMP FOR ABUTTING CURB  
 N.T.S.

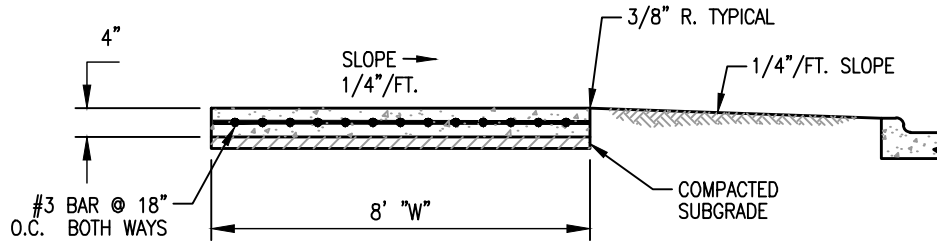

STANDARD TRAIL SECTION  
 N.T.S.

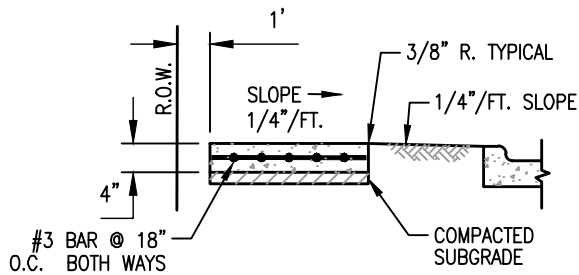

STANDARD SIDEWALK SECTION  
 N.T.S.

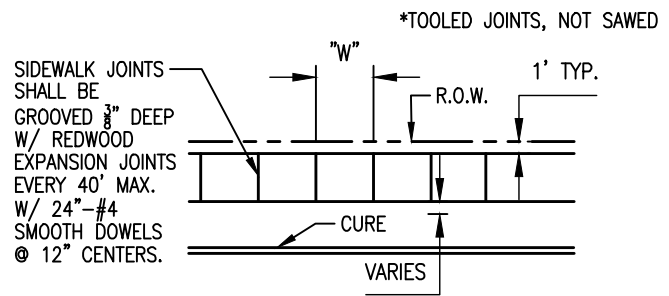

STANDARD SIDEWALK PLAN  
 N.T.S.

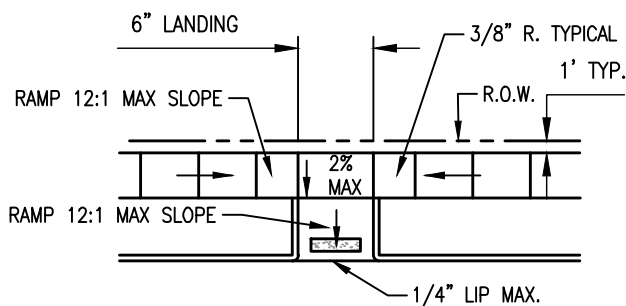

MID-BLOCK RAMP FOR STANDARD WALK  
 N.T.S.

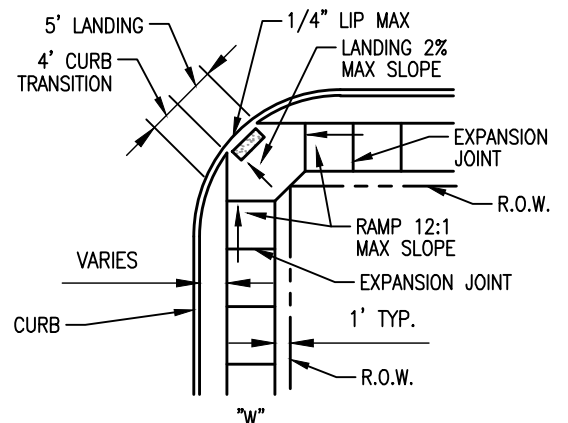

STANDARD INTERSECTION RAMP  
 N.T.S.

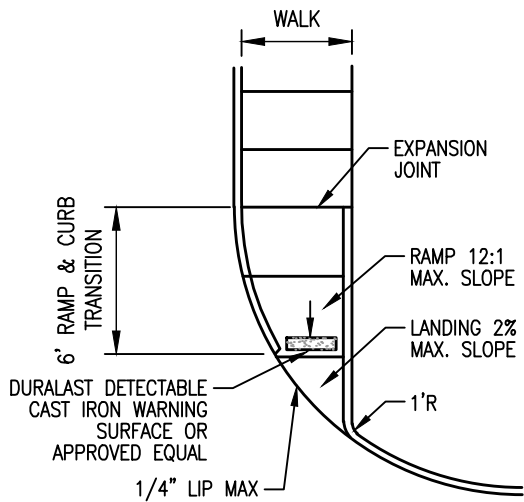

PARALLEL CURB RAMP FOR WALK  
ABUTTING CURB 36" MINIMUM WIDTH  
 N.T.S.

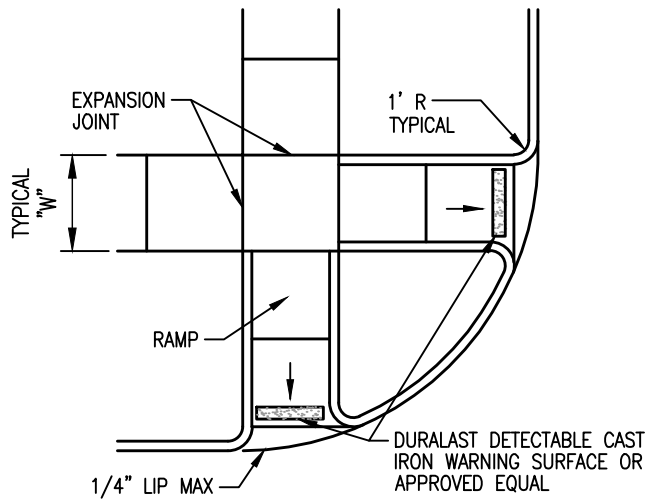

SPLIT RAMPS (STREET RADIUS < 15')  
 N.T.S.

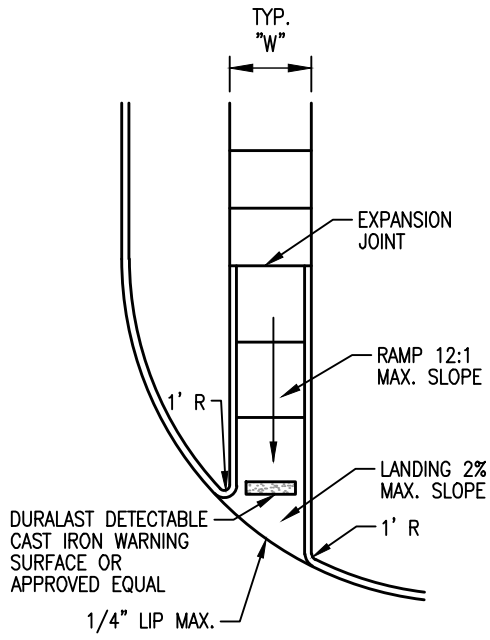

STANDARD PARALLEL CURB RAMP  
 N.T.S.

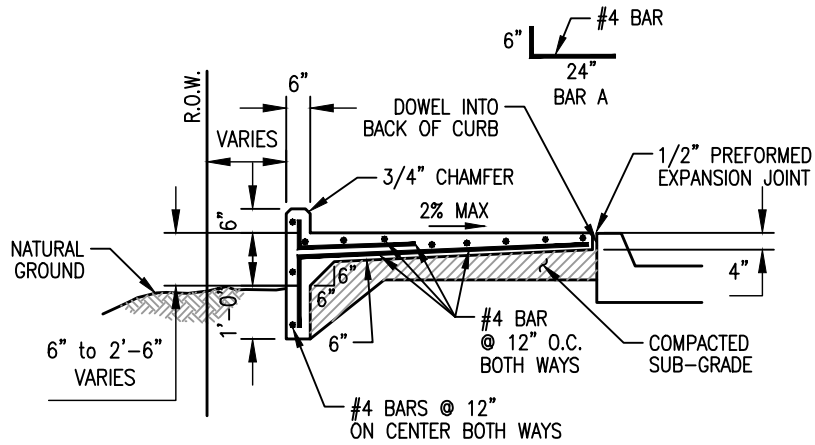

SIDEWALK WITH CURB AND TOEWALL  
N.T.S.

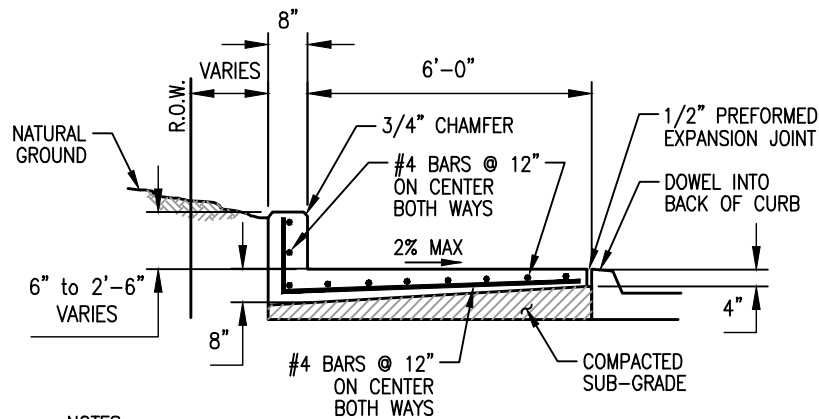

NOTES:

1. INSTALL 1" DIA. PVC WEEP HOLE ON 10' CENTERS.
2. SIDEWALK JOINTING TO BE CONTINUOUS UP FACE OF WALL WITH CHAMFER.
3. INSTALL GRAVEL POCKET BEHIND WALL PER DETAIL WPS-07

SIDEWALK WITH RETAINING WALL  
N.T.S.

SEPTEMBER 2022



TOWN OF WESTLAKE  
1500 SOLANA BOULEVARD  
BLDG. 7, SUITE 7200  
WESTLAKE, TEXAS 76262

SIDEWALK &  
RAMP DETAILS  
WPS-03

SIDEWALK GENERAL NOTES:

1. ALL CONSTRUCTION MATERIALS, METHODS AND PLACEMENT NOT DETAILED BELOW SHALL MEET OR EXCEED THE STANDARD SPECIFICATIONS OF THE NORTH CENTRAL TEXAS COUNCIL OF GOVERNMENTS, LATEST EDITION, UNLESS SUPERSEDED BY THE TOWN OF WESTLAKE STANDARD SPECIFICATIONS OR TESTING POLICIES.
2. CONCRETE SHALL BE A MINIMUM OF 4 INCHES THICK, CLASS "A", (303.3.4.2) CONTAINING A MINIMUM OF 50% CRUSHED STONE (1" MAX.). ALL CONCRETE PLACED SHALL CONTAIN SUFFICIENT AGENT TO YIELD 5% ( $\pm 1\%$ ) AIR CONTENT.
3. CHAMFER ALL EXPOSED EDGES OF CONCRETE WALLS 3/4 INCH.
4. ALL REINFORCED STEEL SHALL BE DEFORMED BARS CONFORMING TO ASTM A-615 GRADE 60. REINFORCING STEEL SHALL BE PLACED WITH A MINIMUM OF 1-1/2 INCH OF COVER FOR #5 BARS OR SMALLER. WHERE REINFORCING BARS ARE SPLICED, A 30 DIAMETER LAP SHALL BE USED. REINFORCED STEEL MUST BE PLACED ON CHAIRS OR STOOLS.
5. SUBGRADE SHALL CONSIST OF NATIVE SOIL COMPACTED TO A DENSITY NOT LESS THAN 95% ASTM DD698, OPTIMUM MOISTURE CONTENT OR ABOVE.
6. SIDEWALKS SHALL BE FINISHED BY LIGHTLY BROOMING SURFACE TRANSVERSE TO THE DIRECTION OF TRAFFIC, WHERE ADJACENT SIDEWALKS DIFFER FROM THIS STANDARD, NEW SIDEWALKS SHALL CONFORM TO ADJACENT SIDEWALK.
7. AN APPROVED WHITE PIGMENT CURING COMPOUND SHALL BE APPLIED EVENLY WITH A SPRAYER TO THE SURFACE OF THE PAVEMENT AS SOON AS IT IS HAS BEEN PLACED AND FINISHED.
8. RETAINING WALLS TO HAVE REDWOOD EXPANSION JOINTS @ 40' MAX. W/24" #4 DOWELS @ 12" CENTERS
9. SIDEWALK JOINTS SHALL BE TOOLED AND NOT SAWED.

GENERAL NOTES:

1. HANDICAP RAMPS AND SIDEWALKS SHALL CONFORM TO THE MOST RECENT STANDARDS OF THE "TEXAS ACCESSIBILITY STANDARDS" (TAS) AND THE "UNIFORM FEDERAL ACCESSIBILITY STANDARDS" ESTABLISHED BY THE AMERICANS WITH DISABILITIES ACT (ADA) OF 1990.

SEPTEMBER 2022



TOWN OF WESTLAKE  
1500 SOLANA BOULEVARD  
BLDG. 7, SUITE 7200  
WESTLAKE, TEXAS 76262

SIDEWALK &  
RAMP DETAILS  
WPS-04

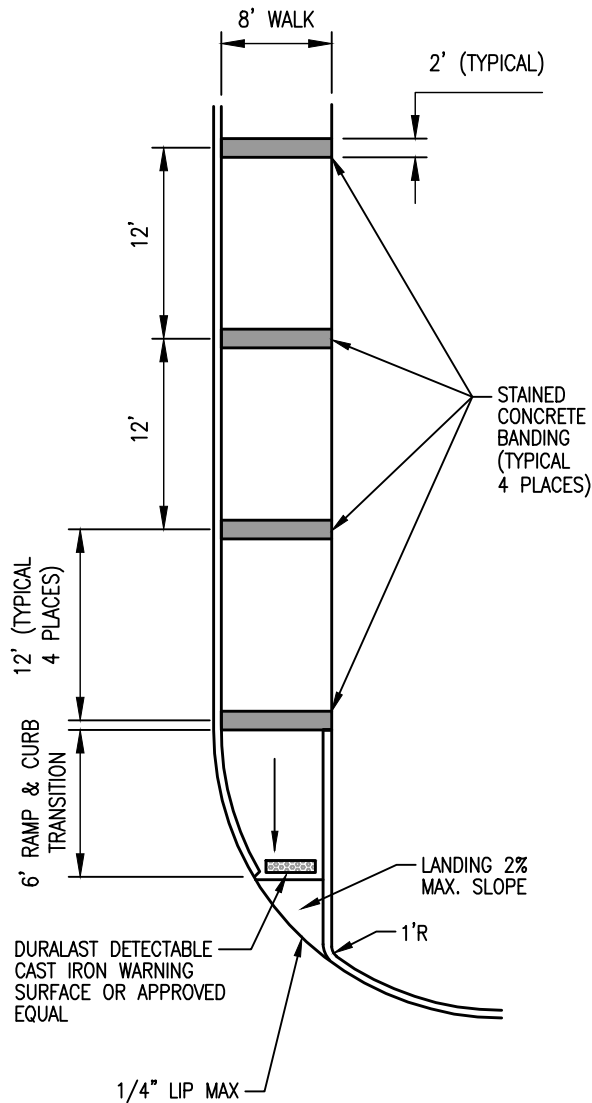

SIDEWALK BANDING PARALLEL CURB RAMP FOR WALK ABUTTING CURB 36" MINIMUM WIDTH  
N.T.S.

STAINED CONCRETE BAND NOTES:  
BOMANITE COLOR HARDENER: CH-00047-60 (CARMEL)  
RELEASE AGENT: CH-00093-60 (FOREST BROWN)  
CH-00119-60 (HARVEST AMBER)  
PAVING PATTERN: SLATE REGULAR

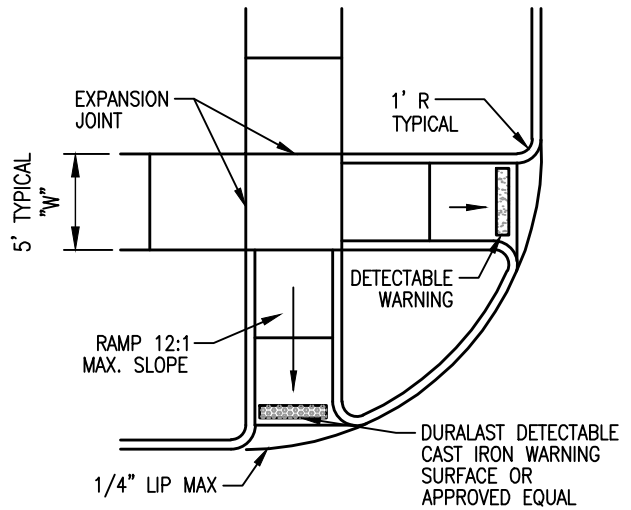

SPLIT RAMPS (STREET RADIUS < 15')  
N.T.S.

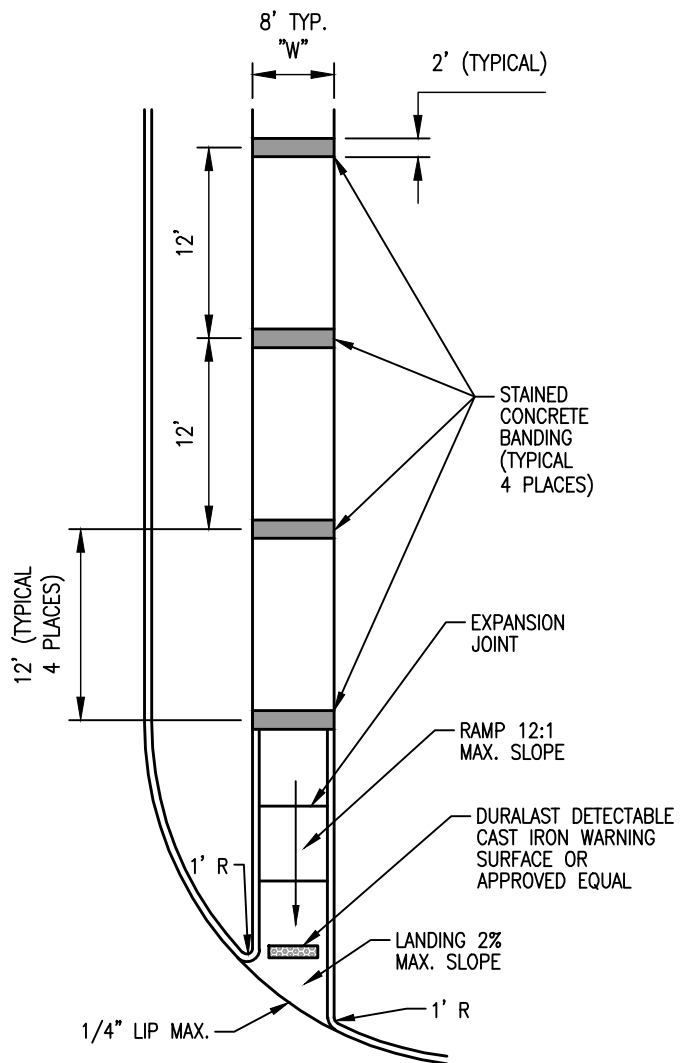

STANDARD PARALLEL CURB RAMP  
N.T.S.

SEPTEMBER 2022



TOWN OF WESTLAKE  
1500 SOLANA BOULEVARD  
BLDG. 7, SUITE 7200  
WESTLAKE, TEXAS 76262

SIDEWALK &  
RAMP DETAILS  
WPS-05

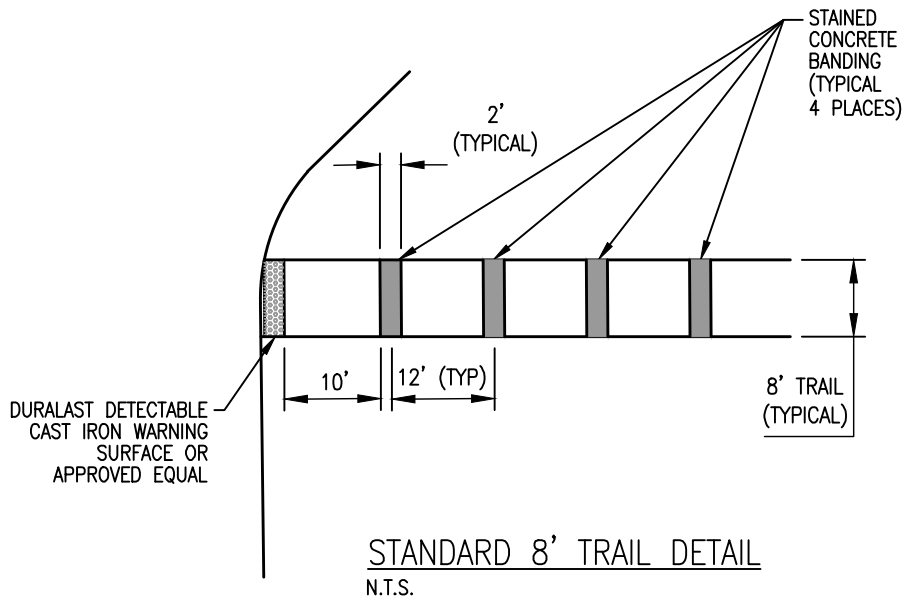

STAINED CONCRETE BAND NOTES:  
 BOMANITE COLOR HARDENER: CH-00047-60 (CARMEL)  
 RELEASE AGENT: CH-00093-60 (FOREST BROWN)  
 CH-00119-60 (HARVEST AMBER)  
 PAVING PATTERN: SLATE REGULAR

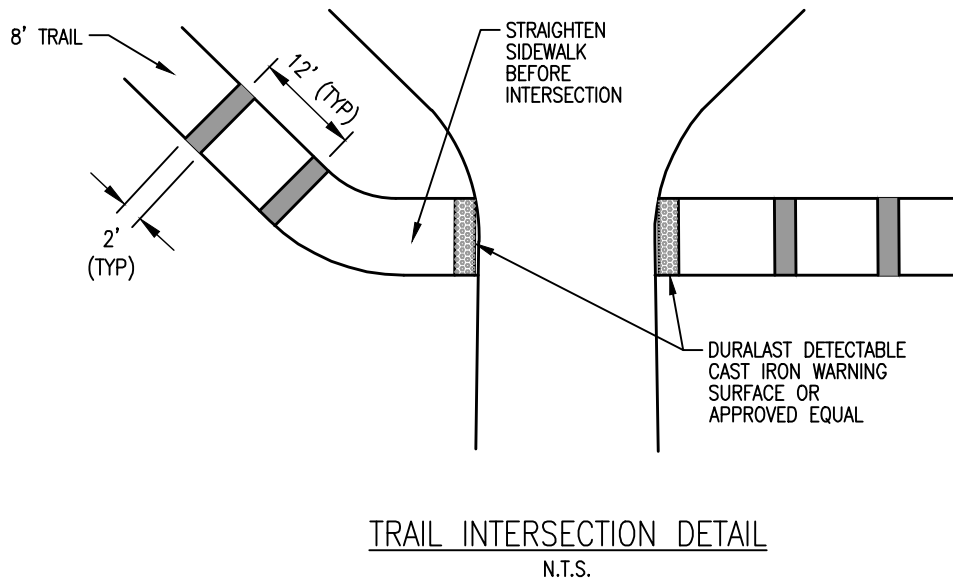

SEPTEMBER 2022



TOWN OF WESTLAKE  
 1500 SOLANA BOULEVARD  
 BLDG. 7, SUITE 7200  
 WESTLAKE, TEXAS 76262

TRAIL & RAMP  
 DETAILS  
 WPS-06